



# HMK MAMMOGRAPHY SCREENING UNIT



**THE PERFECT SOLUTION, WHEN  
MAMMOGRAPHY COMES TO THE PATIENT**

### **MAMMOGRAPHY CLINIC ON WHEELS**

The mobile mammography screening unit is equipped and correspond to a stationary clinic on a hospital.

In all of the design phase focus has been on the patient's perception of visiting the trailer should be similar as to be visiting a stationary clinic in a hospital. Therefore many considerations have been made regarding working ergonomics and productivity, which all have contributed to the final design.

Therefore colouring, furniture and general interior design are all adapted to resemble the actual colours of the doors etc. of the hospitals in the region.

### **SMART INTERIOR DESIGN**

The 34m<sup>2</sup> of the unit is optimized for screening up to 12 persons an hour, without these feeling themselves as a number in the system.

Changing before and after examinations is done in one of the two dressing rooms. First one undresses, before being collected by the nurse. The examination is performed and you return to the dressing room for redressing and exit of the trailer.

As this working process continues from the two dressing rooms a high flow is reached, that makes full use of the screening apparatus.

Emphasis has been put on decorating the examination room with indirect lights, while still preserving the esthetical choice of lamps. The dimmable lights in examination room create therefore a friendly and comfortable environment.

### **USER FRIENDLY**

The complete unit is decorated in bright and attractive colours. All done to give a perhaps unwary patient positive signals and a sense of being well taken care of both mentally and physically, even though it is "only" a trailer she is visiting.



**WAITING ROOM**



**SCREENING ROOM**

## COMPLETE MOBILE CLINIC FOR MAMMOGRAPHY EXAMINATION

The mobile mammography unit is highly mobile and can be positioned anywhere a standard trailer can go.

One person can make the mobile unit ready for patients within 20 minutes. The unit can be equipped with automatic hydraulic suspension legs for perfect stability and horizontal levelling on uneven ground.

The unit is capable of functioning without external electricity due to the internal sound suppressed electrical power generator.

The 13,6 meter long mobile unit consists of staff room, examination room, two dressing rooms, waiting area and toilet facility. Entrance and exit is done in the rear of the trailer where a hydraulic lift is positioned to carry wheelchairs etc. and to work as an external entrance area.

Choices of interior design, such as colours, lamps and chairs can be decided upon the customer. The walls and windows in the examination room are laminated with a layer of lead to assure that no unwanted radiation escapes. Floor heating and air conditioning in the complete unit assures a perfect working environment.



VIEW FROM WAITING AREA

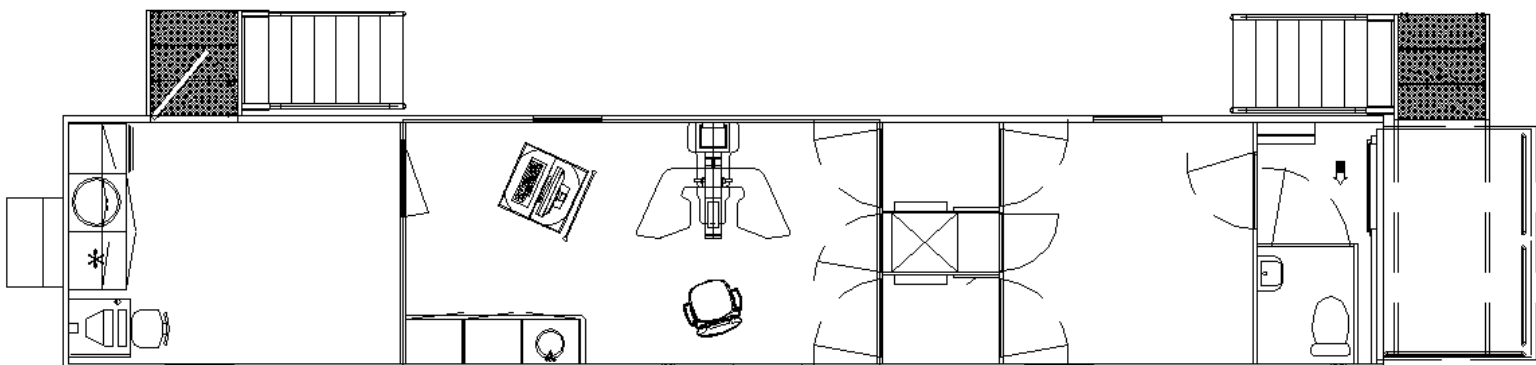

In the staff room as well as in the examination room a internal computer network can connect to the mainframe system of the nearby hospitals, where the doctor can examine the screening data.

The staff room is equipped with 4 lockers for the staff's personal belongings, as well as a fridge and kitchen with water and sink.

## DIMENSIONER

	<b>Exterior:</b>	<b>Internal:</b>
Length:	13,6 m	
Width:	2,55 m	2,44 m
Total height:	4,00 m	
Internal height:		2,30 m
Entrance height:	1,10 m	
Total floor area:		Approx. 34 m <sup>2</sup>
Net weight:	Approx 12.000 kg. depending on the choice in interior design and screening apparatus.	

The clinic is equipped with air conditioning, floor heating and toilet facilities. Furthermore radio in examination room with loudspeakers in all rooms. Staff room has fridge and micro wave oven.



FOR FURTHER INFORMATION PLEASE CONTACT: